



Vista Fold™



**THERMALLY BROKEN:
IMPACT & NON-IMPACT RATED**
Folding Door System



#27023



Comfortable & Captivating



Looking to add the perfect blend of beauty and performance to your space? Vista Fold™ thermally broken impact and non-impact folding door systems are the clear choice. Now you can have unobstructed views and seamless transitions to the outside with increased energy efficiency. Engineered with precision, these doors feature a thermal barrier that effectively reduces heat and cold transfer, maintaining comfortable indoor temperatures while minimizing energy consumption. Our innovative folding components optimize your space, bringing the outdoors in. With sleek aluminum frames that provide strength and durability, these doors are a testament to modern design and sustainable living.

At Euro-Wall, everything we do is Superior by Design. We constantly push ourselves to provide the highest quality doors with the largest views to give you the freedom to design without limitations.



Features & Benefits

Largest Panel Sizes

Enjoy the view through the industry's largest panels (14' tall / 54" wide available).

Design Flexibility

Make it yours with custom colors, interior wood clad, custom muntin, simulated divided lites, mid-rails and other aesthetic offerings.

Matching Fixed Units

Create a complementary aesthetic with matching transom and sidelight units.

Long Lasting Finish

Lakefront, oceanfront and everywhere in between, enjoy your door for years to come with the highest quality finish options available.

Configurations

Choose from straight, segmented, radius, split height and 90° postless corner units.

System Thresholds

MAXIMUM / MINIMUM SPECIFICATIONS

	IMPACT RATED	NON-IMPACT RATED
MAX. PANEL WEIGHT	350 lbs	350 lbs
MAX. PANEL HEIGHT	144"	169"
MAX. PANEL WIDTH	54"	54"
MIN. PANEL HEIGHT	20"	20"
MIN. PANEL WIDTH	20"	20"
MAX. OPENING	334 ft ²	UNLIMITED

Note: When using maximum panel widths & heights, panels may exceed maximum panel weight of 350 lbs. Calculated weight check should be done. For installations in Florida, please see the Florida Product Approval (#27023) for usage and limitations.



10-Year Limited Warranty

Euro-Wall warrants the products to be free from manufacturing defects for a period of 10 years.

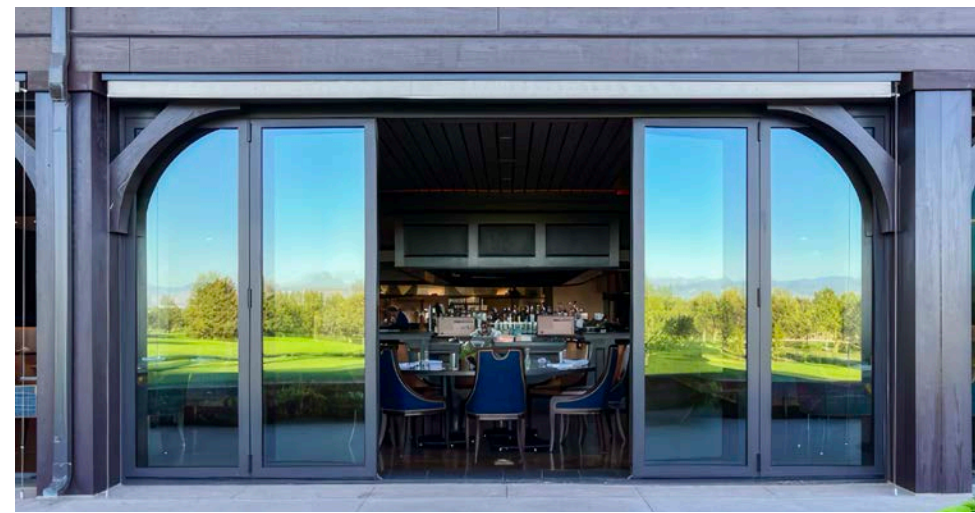

System Components

1 Multipoint Door Lock



2 Twinpoint Lever (INTERIOR)



3 Pull Handle (INTERIOR)



4 Upper Jamb Hinge



5 Center Wall Pivot



6 Lower Jamb Hinge



7 Upper Intermediate Carrier



8 Lower Intermediate Carrier



Sill Options

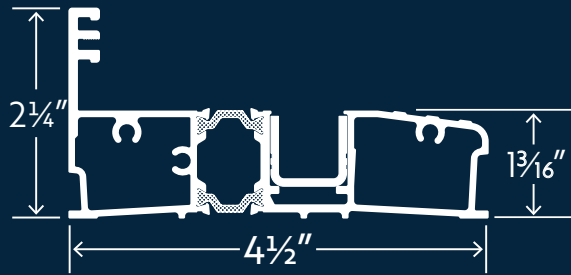

STANDARD SILL
Water-Rated

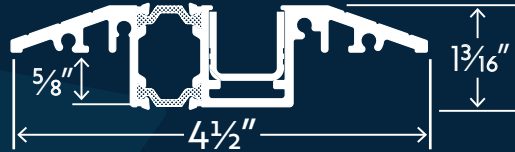

ADA SILL



MODIFIED STANDARD SILL

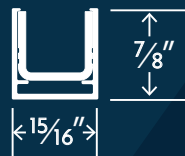

CHANNEL SILL
Not Thermally Broken

Finish Options

STANDARD FRAME & DOOR PANEL FINISHES

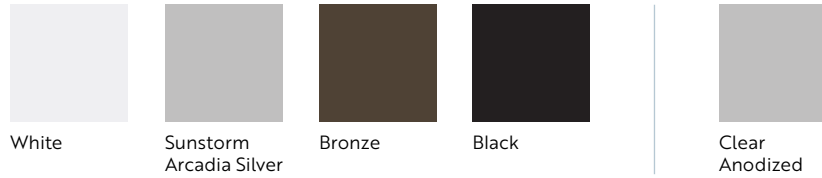

Standard finish is Sunstorm Arcadia Silver (Kynar® Amma 2605)

FRAME & DOOR PANEL FINISHES

- Kynar® Liquid Paint or Powder Coat finishes available
- Custom powder coat or Kynar® finishes available
- Custom faux woodgrain finishes available

INTERIOR WOOD CLAD FINISH OPTION

- Mahogany / sapele
- White oak
- Additional wood species available



Wood clad veneer option shown

Hardware / Handle Finish Options

Custom handle options available

MULTIPOINT LOCK HANDLE



Polished Stainless Steel
Brushed Satin
Bronze
Black

TWINPOINT LEVER



Sunstorm Arcadia Silver
White
Brushed Satin
Bronze
Black
Custom Colors Available

HINGES / HARDWARE



White
Brushed Satin
Bronze
Black

Note: The colors shown are an approximation of actual colors and finishes. Actual finishes may vary slightly.



Note: The configurations on this page are just a few examples of the numerous possibilities for Vista Fold™ layout options.

Standard Configurations

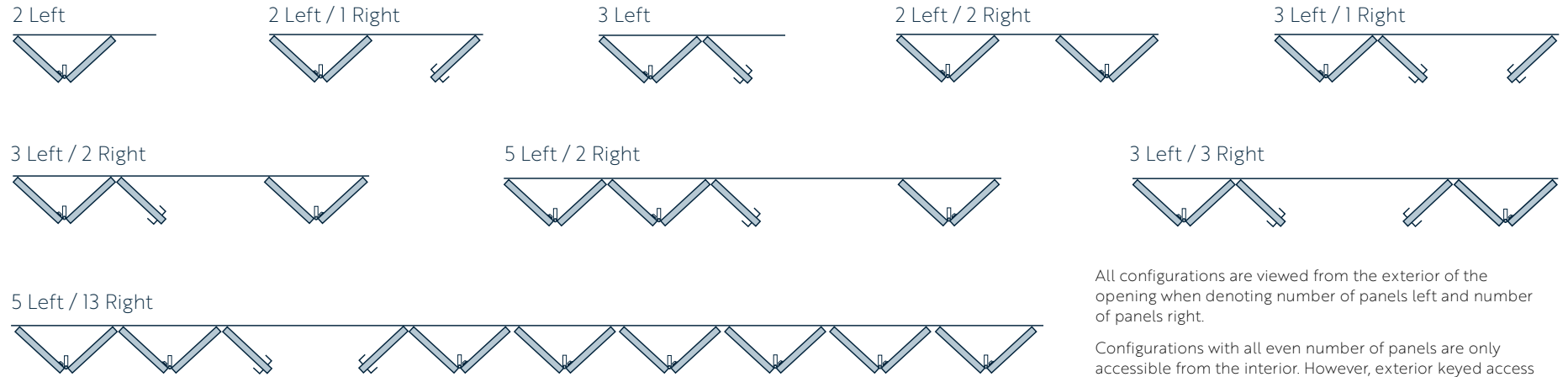

All configurations are viewed from the exterior of the opening when denoting number of panels left and number of panels right.

Configurations with all even number of panels are only accessible from the interior. However, exterior keyed access is available upon request.

Specialty Configurations

POSTLESS CORNER

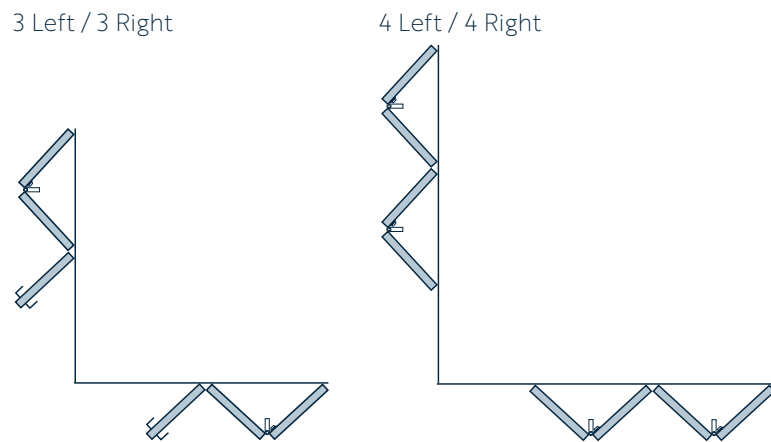

SPLIT LEVEL

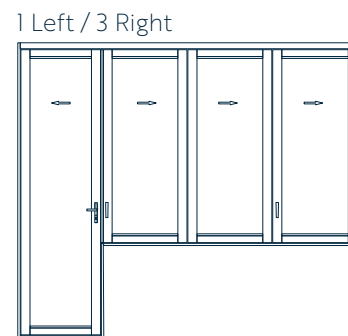

SPECIALTY

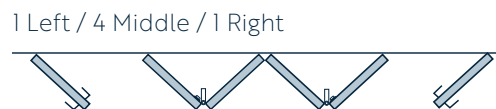

RADIUS

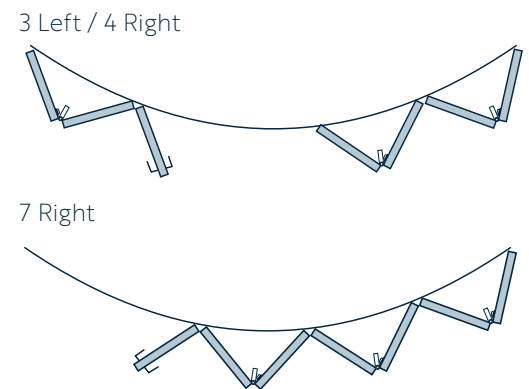



Panel Cross Section

OUTSWING CONFIGURATION SHOWN

Standard Sill Shown

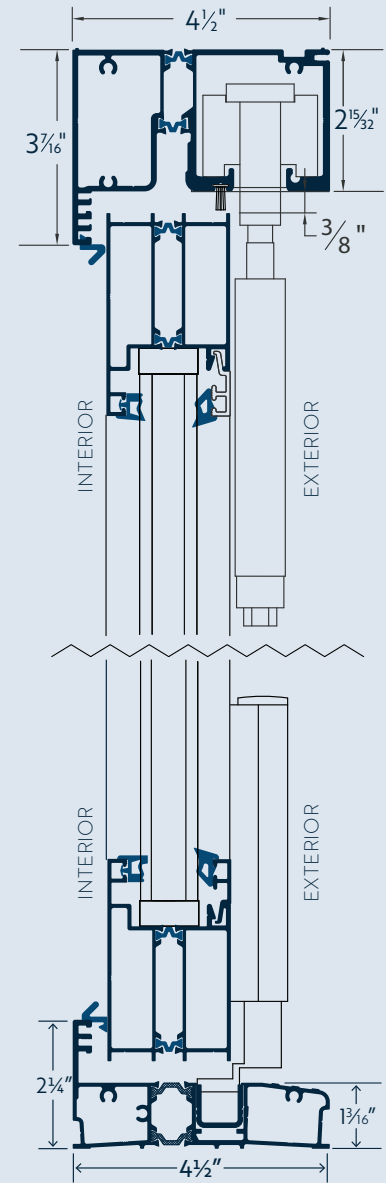

Glazing Details

OVERALL GLASS THICKNESS 1/4" | 3/8" | 1/2" | 9/16" | 1"

We can handle most any type of glass if it meets the required thickness. *Let's talk.*

9/16" LAMINATED GLASS PROFILE SHOWN

Stile

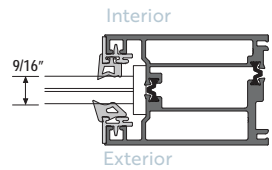

Top Bottom Rail

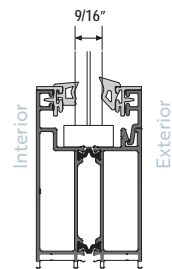

1" INSULATED GLASS PROFILE SHOWN

Stile

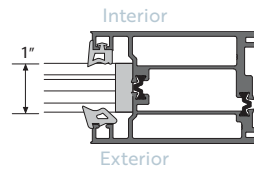

Top Bottom Rail

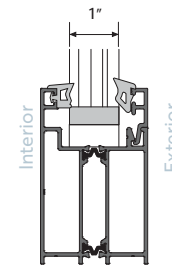

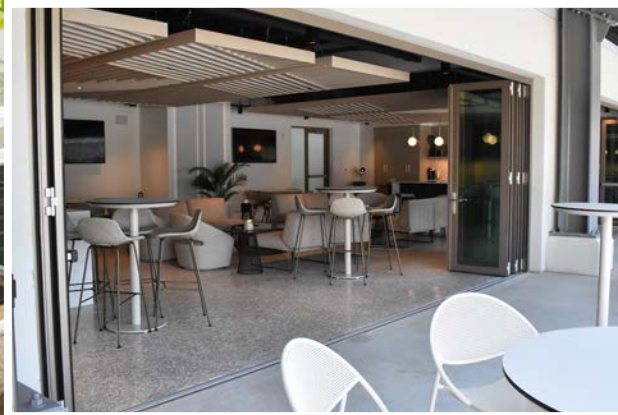

IS YOUR *vision* BLOCKED?

If you have questions about Vista Fold™, our FOR YOU Crew™ is always ready to clear things up with friendly, one-on-one support.





euro-wall.com



American Made.
EUROPEAN INSPIRED.

MANUFACTURING & SHOWROOM

2200 Murphy Ct.
North Port, FL 34289
888.989.EURO (3876)

SHOWROOM

1211 Stirling Rd., Unit 102,
Dania Beach, FL 33004
941.979.5316

EURO-WALL UNLOCKS *brehtaking perspectives* THROUGH THE *largest, strongest* DOOR SYSTEMS WITH THE MOST DESIGN OPTIONS – ALL BACKED BY *enjoyable, personal* SUPPORT – FOR A *superior experience* FROM OPEN TO CLOSE.



© 2024 Euro-Wall, LLC. Unless Otherwise noted, all proprietary names are trademarks of Euro-Wall. All rights reserved.

