



EURO VISTA PIVOT™

IMPACT RATED ALUMINUM PIVOT DOORS



Approved for use in Miami-Dade HVHZ Zones
Florida Building Code Approved
Product Approval FL 22410

www.euro-wall.com
888.989.EURO (3876)

euro-wall®



FOLDING



SLIDING



STACKING



PIVOT

SYSTEM THRESHOLDS

Maximum / Minimum Specifications

Max Panel Weight:	700 lbs
Max Panel Height:	168"
Max Panel Width:	100"
Min Panel Height:	48"
Min Panel Width:	36"
Panel Thickness:	2-1/4"

NOTE: The Euro Vista Pivot™ door comes in aluminum, aluminum with interior wood clad, or an interior/exterior faux wood grain kynar finish. The Euro Pivot™ door can be configured as either an outswing or an inswing. For installations in Florida, please see the Florida Product Approval 24410 for usage and limitations.

SYSTEM HIGHLIGHTS

Aluminum Pivot Panel Specifications

Extruded aluminum 6063-T5 with door panel corner keys for strength and security / optional wood clad finish available

Hardware

Stainless steel (316/304SS) components

Lever Lock Sets

Jamb latch, bottom shootbolt and top shootbolt locking system

Multi-point Door Locks

Faceplate, latch and hooks are 304SS

Fully Flush Thresholds

No sills necessary

Water Management

Water management system option available

Matching Fixed Units

Matching Florida Product Approved impact rated transom and sidelight units available

Largest Impact Rated Panel Sizes

168" tall / 100" wide panels - the largest available Wind Zone 3 and HVHZ impact tested and Florida Product Approved pivot door

Under Pressure

Design pressure available for any impact rated pivot door - up to 60+/-

Aesthetics

A multitude of customization options allow for flexible and functional design - muntins, simulated divided lites, mid-rails, custom wood cladding, custom aluminum cladding

Ladder Pull Handle

Available in sizes ranging from 1' - 8' to meet the needs of your application

Long Lasting Finish

Standard finish coating is AAMA 2605, the highest quality finish available



SYSTEM COMPONENTS / OPERATION

(Inswing and Outswing Illustrated Options Below)

TOP VIEW - Horizontal Cross Section

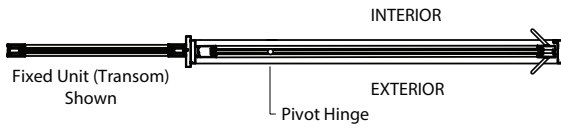

RIGHT HAND OUTSWING

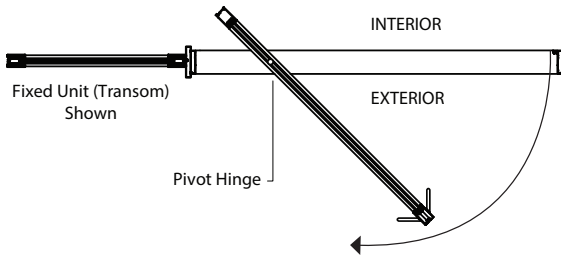

LEFT HAND INSWING

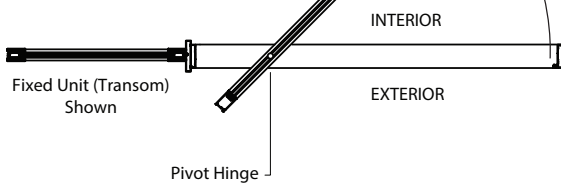

NOTE: Right hand inswing and left hand outswing are also available

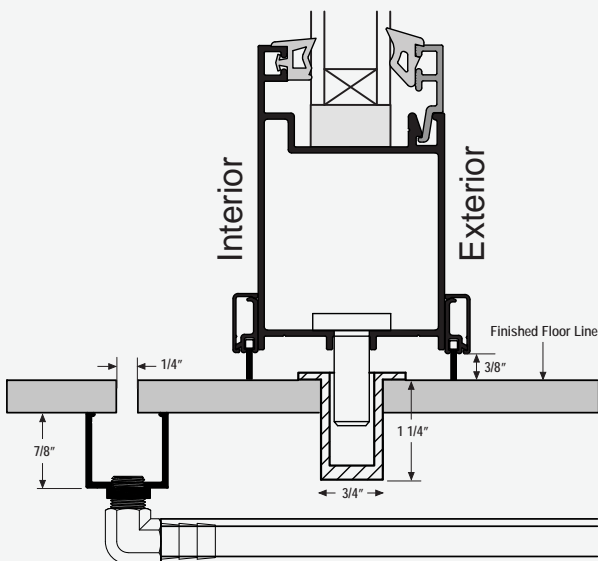
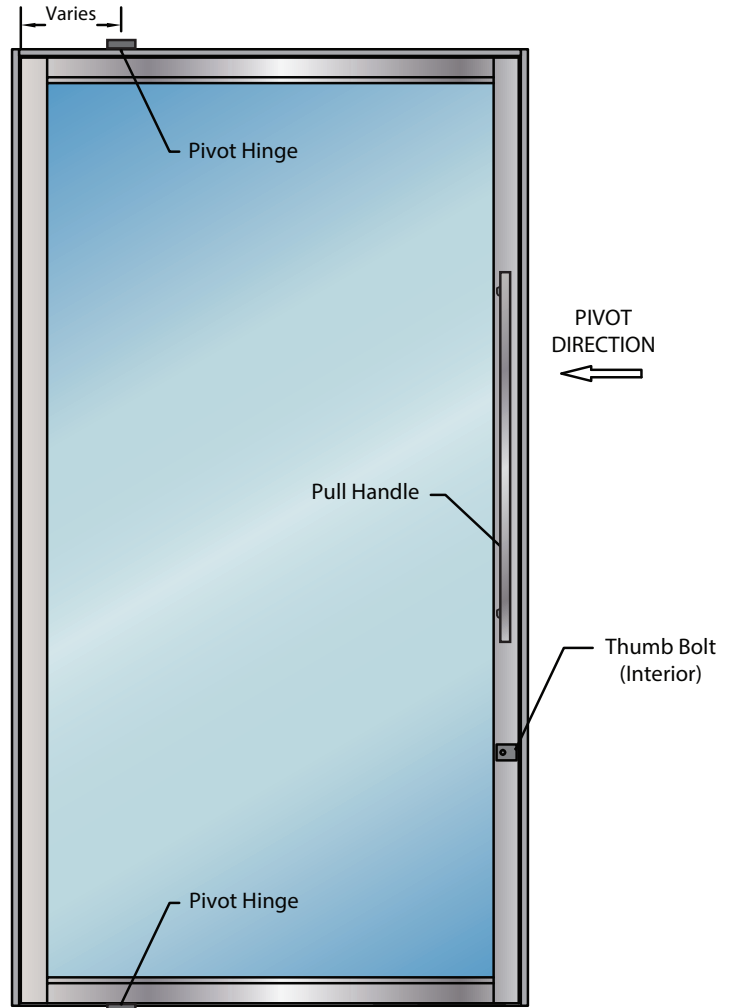

OPTIONAL DRAINAGE SYSTEM

Euro-Wall offers an optional water management system that allows water to drain away from the pivot door location. NOTE: This is a non water rated door in the state of Florida.

PANEL FINISH OPTIONS

STANDARD FRAME & ALUMINUM PANEL FINISHES

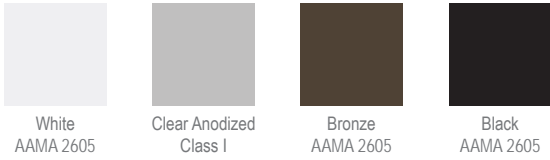

- Powder coat or Kynar® finishes available
- Custom powder coat or Kynar® finishes available
- Manufacturer color match options

STANDARD WOOD CLAD FINISHES



FAUX WOOD GRAIN FINISHES

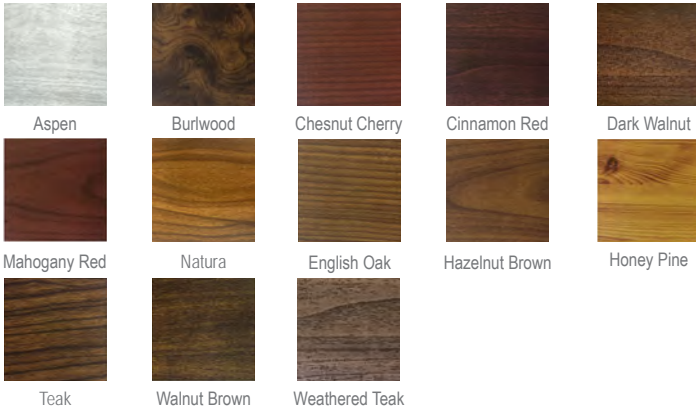

A faux wood finish is a powder coat with die sublimation to an AAMA 2604 finish qualification. Additional faux wood grain options available upon request.

EXOTIC WOOD FINISHES

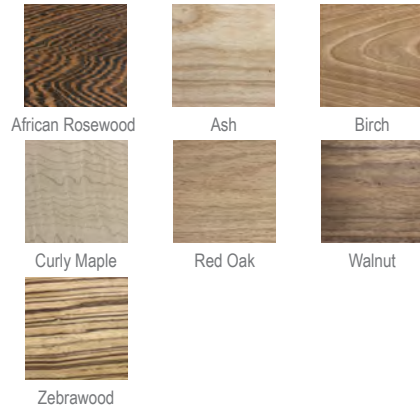

Additional exotic wood finish options available upon request.

HANDLE OPTIONS

MULTIPOINT LOCK HANDLE



- Available Finishes**
- Polished Stainless Steel
 - Brushed Satin
 - Bronze
 - Black

LADDER PULL HANDLE



- Available Finishes**
- Polished Stainless Steel
 - Brushed Satin
 - Bronze
 - Black
 - White

EURO VISTA PIVOT™ DOOR PANEL OPTIONS

The illustrations below are just a few possible design examples.

NOTE: All doors are available in finished aluminum, interior wood clad or an interior/exterior faux wood grain finish.

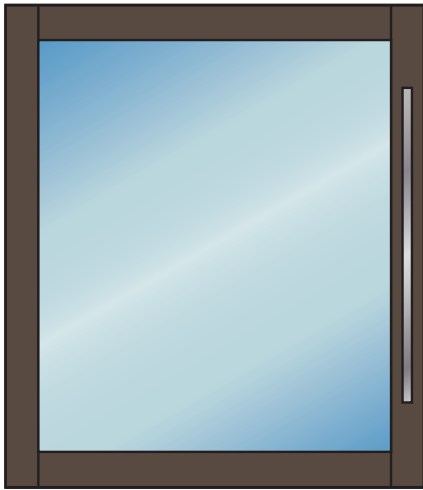

1



2

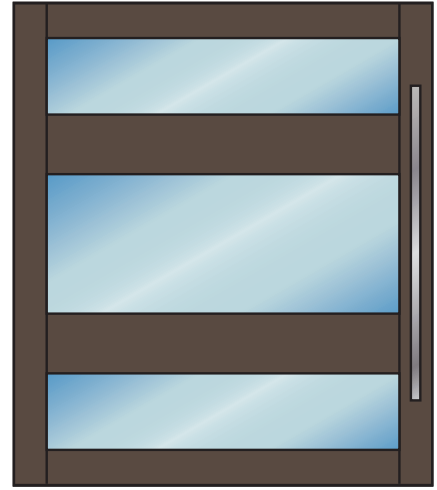

3

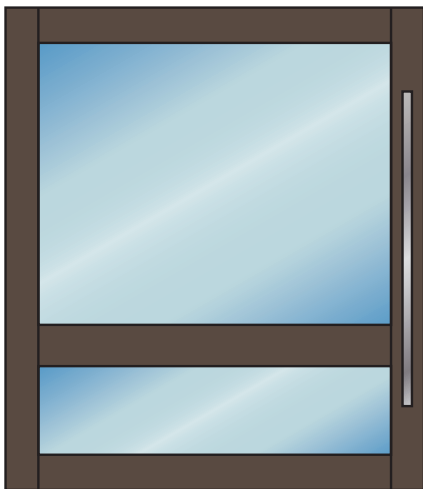

4

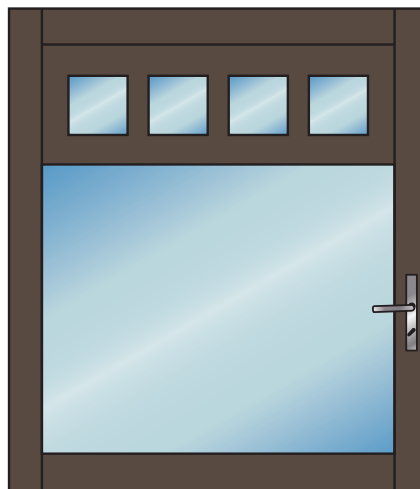

5

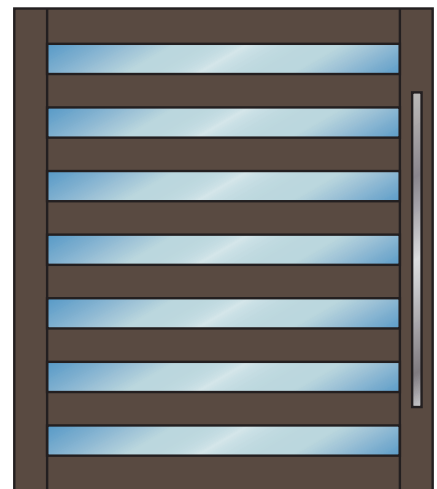

6

NOTE: Illustrations 7, 8, & 9 are examples of interior wood clad or full coverage faux wood grain finishes. These configurations are also available in solid color aluminum.



7

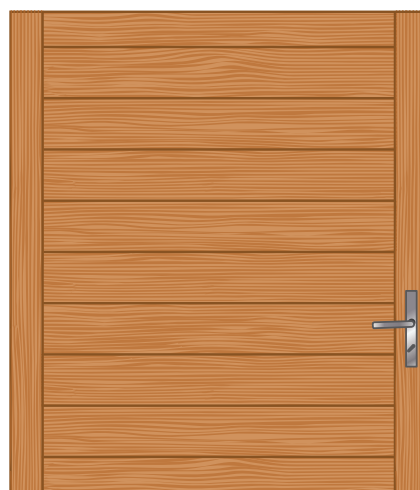

8



9

PANEL & GLAZING CROSS SECTIONS

PANEL CROSS SECTION

Outswing Extrusion Shown
1" Insulated Impact Glass Shown

Aluminum Pivot Door

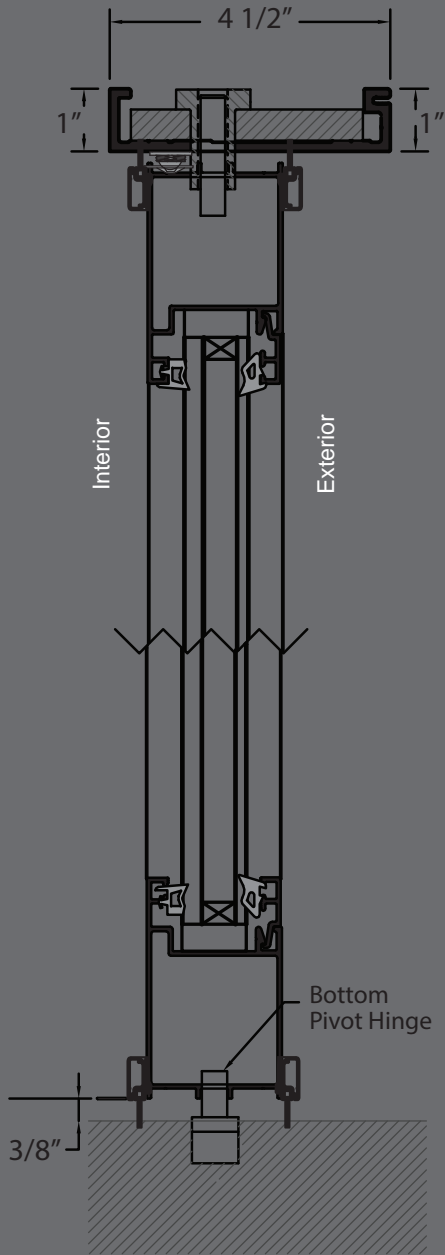

GLAZING DETAILS

Available impact glass options for the Euro Vista Pivot™:

Aluminum Pivot Door

- IG Impact
- 9/16" Impact Monolithic

9/16" Monolithic • Impact Rated

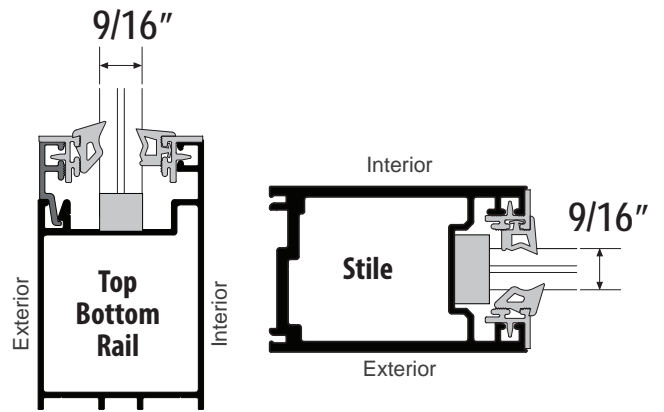

1" Insulated Glass • Impact Rated

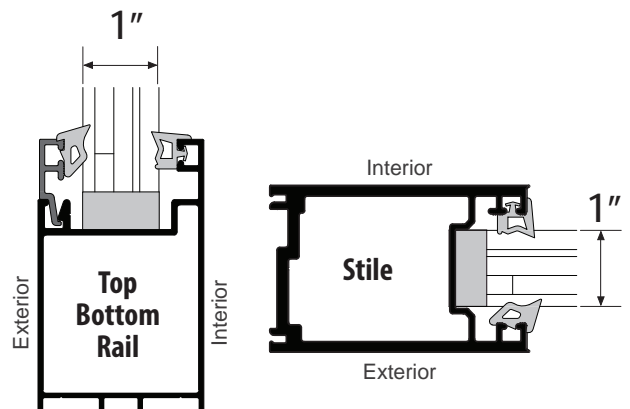

Other glass options available for non-impact applications: 1/2" - 1"

TEST PERFORMANCES

Euro Vista Pivot™ Impact Rated Pivot Door

- Approved for use in Miami-Dade HVHZ Zone
- Florida Building Code Approved Product Approval FL 22410
- TAS 201 TAS 202 TAS 203
- AAMA / WDMA / CSA 101 / I.S.2 / A440-08 • NAFS-08
- Air Infiltration: A2
- Water Leakage Resistance: 60 DP
- Wind Load Resistance: 60 DP
- Wind Zone 4 (Hurricane) ASTM (cycling) E1996: DP60
- Wind Zone 4 (Hurricane) ASTM (impact) E1886: Pass
- Tested for Thermal Requirements

DESIGN PRESSURE CHART

Wind Zone 3 Width & Height Design Pressure Chart

		Panel Width (Inches)										
		60	64	68	72	76	80	84	88	92	96	100
Panel Height (Inches)	72	60	60	60	60	60	57	54.55	52.5	50.77	49.29	48
	78	60	60	60	60	60	56.84	54.03	51.69	49.73	48.07	46.64
	84	60	60	60	60	60	56.84	54	51.43	49.19	47.31	45.71
	90	60	60	60	60	60	56.84	54	51.43	49.09	46.98	45.18
	96	60	60	60	60	60	56.84	54	51.43	49.09	46.96	45
	102	60	60	60	60	60	56.84	54	51.43	49.09	46.96	45
	108	60	60	60	60	60	56.84	54	51.43	49.09	46.96	
	114	60	60	60	60	60	56.84	54	51.43			
	120	60	60	60	60	60	56.84	54				
	126	60	60	60	60	60	56.84					
	132	60	60	60	60	59.87						
	138	60	60	60	60							
	144	60	60	60	58.92							
	150	60	60	60								
	156	60	60									
	162	60	60									
168	60											

HVHZ Width & Height Design Pressure Chart

		Panel Width (Inches)										
		60	64	68	72	76	80	84	88	92	96	100
Panel Height (Inches)	72	60	60	60	60	60	57	54.55	52.5	50.77	49.29	48
	78	60	60	60	60	60	56.84	54.03	51.69	49.73	48.07	46.64
	84	60	60	60	60	60	56.84	54	51.43	49.19	47.31	45.71
	90	60	60	60	60	60	56.84	54	51.43	49.09	46.98	45.18
	96	60	60	60	60	60	56.84	54	51.43	49.09	46.96	45
	102	60	60	60	60	60	56.84	54	51.43	49.09	46.96	45
	108	60	60	60	60	60	56.84	54	51.43	49.09	46.96	
	114	60	60	60	60	60	56.84	54	51.43			
	120	60	60	60	60	60	56.84	54				
	126	60	60	60	60	60	56.84					
	132	60	60	60	60	59.87						
	138	60	60	60	60							
	144	60	60	60	60							

Minimum Pivot Offset from Jamb WZ3 & HVHZ

Panel Width (Inches) –	44	48	52	56	60	64	68	72	76	80	84	88	92	96	100
Min. Pivot Placement (Inches) –	7	7	7	7	7	7	8	11	14	18	21	24	26	29	32

Pivot placement can be located anywhere from minimum offset from jamb to center of panel.



EURO-WALL 10 YEAR WARRANTY

Euro-Wall warrants the products to be free from manufacturing defects for a period of 10 years from the date of purchase.

888.989.EURO (3876)

www.euro-wall.com

MANUFACTURING

2200 Murphy Court
North Port, Florida 34289
888.989.3876 • 941.979.5316

euro-wall®

FOLDING | SLIDING | STACKING | PIVOT

SHOWROOM

1211 Stirling Road, Unit 102,
Dania Beach, Florida 33004
954.610.2572

Proud Member of the American Architectural Manufacturers Association.

